

Shackles & Eyebolts

Bow Shackle – Square Head Pin

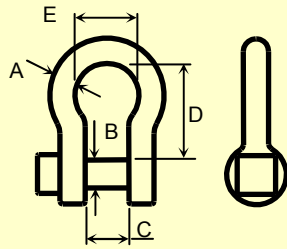

SWL 6:1 Tons	A mm	B mm	C mm	D mm	E mm	Kg	Suggested Towing Head
2.00	13	16	22	51	32	0.34	Upto 75mm
3.25	16	19	26	64	43	0.63	
4.75	19	22	31	76	51	0.95	90-140mm
6.50	22	25	36	83	58	1.55	160-280mm
8.50	25	28	43	95	68	2.30	
9.50	28	32	47	108	75	3.24	
12.00	32	35	51	115	83	4.40	
13.50	35	38	57	133	92	6.00	315-355mm
17.00	38	42	60	146	99	7.50	400-500mm
25.00	45	50	74	178	126	14.00	

‘D’ Shackle – Square Head Pin

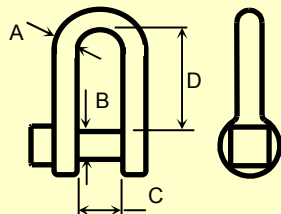

SWL 6:1 Tons	A mm	B mm	C mm	D mm	Kg	Suggested Towing Head
2.00	13	16	22	43	0.34	Upto 75mm
3.25	16	19	26	51	0.63	
4.75	19	22	31	59	0.95	90-140mm
6.50	22	25	36	73	1.55	160-280mm
8.50	25	28	43	85	2.30	
9.50	28	32	47	90	3.24	
12.00	32	35	51	94	4.40	
13.50	35	38	57	115	6.00	315-355mm
17.00	38	42	60	127	7.50	400-500mm
25.00	45	50	74	149	14.00	

High Tensile Blue Pin Shackles

(We can also supply Green Pin Shackles and different styles of shackle pins.)



Eyebolts, Bownuts, etc.



High Tensile Long
Shank Eyebolts



“Dynamo”
Eyebolts



Bownuts

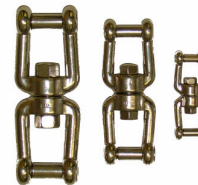

Swivelling Shackles



High Tensile
“Towing Head”
Eyebolts

© Brewis Engineering Limited, January 2005.